

# Gebrauchs- und Montageanleitung

Weintemperierschrank, integrierbar, Festtür

D

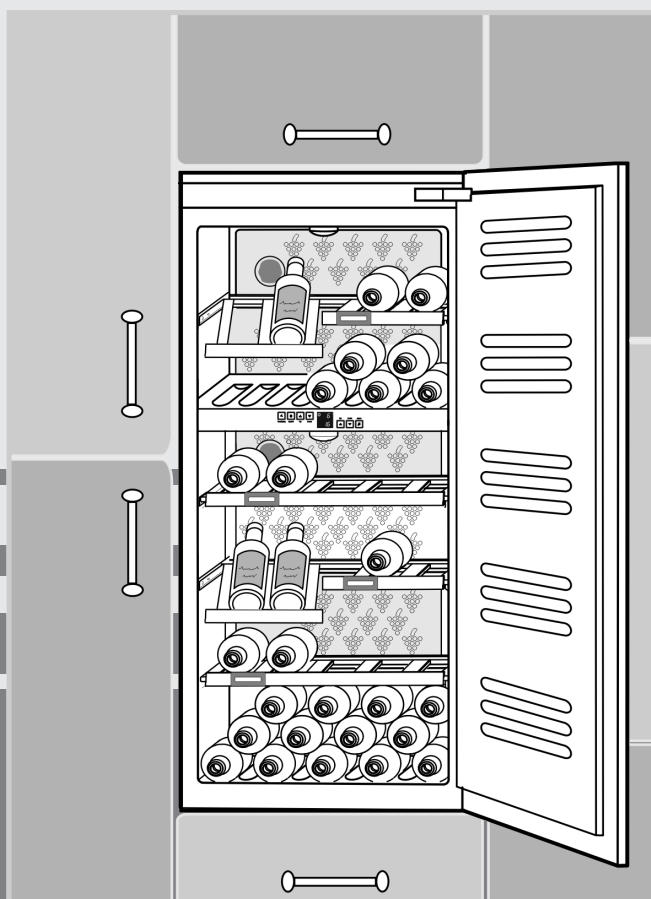

7084026 - 01

WTI ... 6

**LIEBHERR**

# Appliance at a glance

## Contents

<b>1</b>	<b>Appliance at a glance</b> .....	<b>14</b>
1.1	Description of appliance and equipment.....	14
1.2	Range of appliance use.....	14
1.3	Conformity.....	15
1.4	External dimensions of the appliance.....	15
1.5	Saving energy.....	15
<b>2</b>	<b>General safety information</b> .....	<b>15</b>
<b>3</b>	<b>Controls and displays</b> .....	<b>16</b>
3.1	Operating and control elements.....	16
3.2	Temperature display.....	16
<b>4</b>	<b>Putting into operation</b> .....	<b>16</b>
4.1	Transporting the appliance.....	16
4.2	Installing the appliance.....	16
4.3	Changing over door hinges.....	17
4.4	Installation.....	18
4.5	Disposing of packaging.....	21
4.6	Connecting the appliance.....	21
4.7	Switching on the appliance.....	21
<b>5</b>	<b>Control</b> .....	<b>21</b>
5.1	Brightness of the temperature display.....	21
5.2	Child proofing.....	21
5.3	Door alarm.....	22
5.4	Temperature alarm.....	22
5.5	Storing wine bottles.....	22
5.6	Setting the temperature in the wine zone.....	22
5.7	Fan.....	22
5.8	Labels.....	22
5.9	Wooden shelf.....	22
<b>6</b>	<b>Maintenance</b> .....	<b>23</b>
6.1	Replacing the activated charcoal filter.....	23
6.2	Cleaning the appliance.....	23
6.3	Customer service.....	23
<b>7</b>	<b>Malfunction</b> .....	<b>23</b>
<b>8</b>	<b>Decommissioning</b> .....	<b>24</b>
8.1	Switching off the appliance.....	24
8.2	Taking the appliance out of service.....	24
<b>9</b>	<b>Disposing of the appliance</b> .....	<b>24</b>

The manufacturer works constantly on the further development of all the types and models. Therefore please understand that we have to reserve the right to make design, equipment and technical modifications.

To get to know all the benefits of your new appliance, please read the information contained in these instructions carefully.

**Instructions for action are marked with a ►, the results of action are marked with a ▷.**

## 1 Appliance at a glance

### 1.1 Description of appliance and equipment

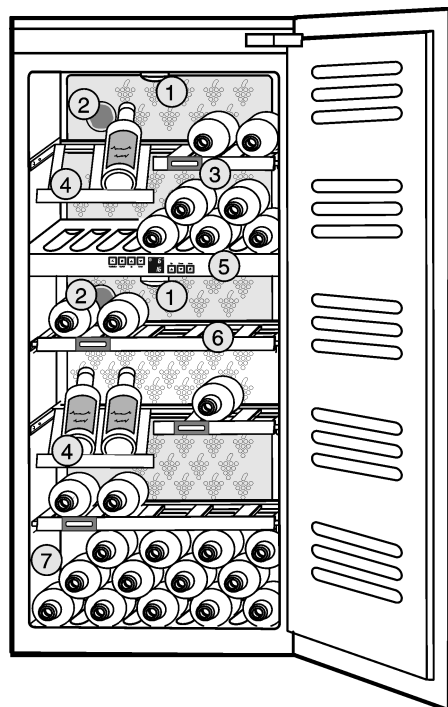

Fig. 1

- (1) Interior light
- (2) Activated charcoal filter
- (3) Label
- (4) Wooden shelf, folding
- (5) Operating and display elements
- (6) Wooden shelf
- (7) Type plate

### 1.2 Range of appliance use

The appliance is suitable solely for storing wine in a domestic environment or similar. This includes use in, for example

- in staff kitchenettes, bed and breakfast establishments,
- by guests in country homes, hotels, motels and other forms of accommodation,
- in catering and similar services in the wholesale trade

Use the appliance solely as is customary within a domestic environment. All other types of use are inadmissible. The appliance is not suitable for storing and cooling medicines, blood plasma, laboratory preparations or similar substances and products covered by the 2007/47/EC Medical Devices Directive. Misuse of the appliance can result in the stored products suffering harm or perishing. Furthermore, the appliance is not suitable for operation in potentially explosive atmospheres.

The appliance is set to operate within specific ambient temperature limits according to its climate rating. The correct climate rating for your appliance is indicated on the type plate.

#### Note

► Compliance with the ambient temperatures indicated is required, otherwise the cooling performance is reduced.

Climate rating	for ambient temperatures of
SN	10 °C to 32 °C
N	16 °C to 32 °C
ST	16 °C to 38 °C

Climate rating	for ambient temperatures of
T	16 °C to 43 °C

## 1.3 Conformity

The refrigerant circuit is tested for leakage. When built-in the appliance complies with the relevant safety regulations and EC Directives 2006/95/EC, 2004/108/EC, 2009/125/EC and 2010/30/EU.

As energy efficiency guidelines for multi-temperature wine cabinets are not available, wine compartments are evaluated as cellar temperature compartments for energy efficiency class allocation.

## 1.4 External dimensions of the appliance

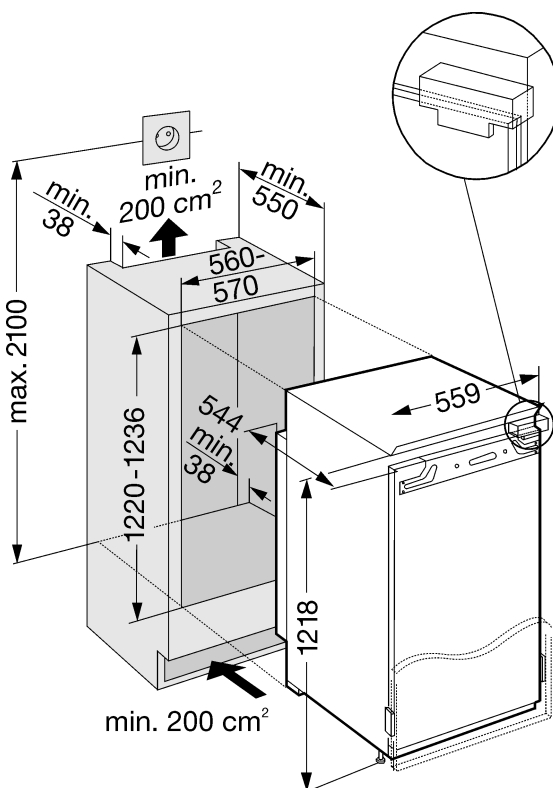

Fig. 2

## 1.5 Saving energy

- Always ensure good ventilation. Do not cover ventilation openings or grille.
- Do not place appliance in areas of direct sunlight or next to a stove, heater or similar object.
- The energy consumption depends on the installation conditions, e.g. the ambient temperature (see 1.2).
- Keep the time the appliance is open to a minimum.
- The lower the temperature setting, the higher the power consumption.

## 2 General safety information

### Danger for the user:

- This appliance can be used by children of 8 years old and over, and also by persons with restricted physical, sensory or mental

capacity or lack of experience and knowledge, if they are supervised or have been instructed on safe use of the appliance and understand the resulting risks. Children must not be allowed to play with the appliance. Cleaning and user maintenance must not be carried out by children without supervision.

- When disconnecting the appliance from the supply, always take hold of the plug. Do not pull the cable.
- In the event of a fault pull out the mains plug or deactivate the fuse.
- Do not damage the mains power cable. Do not operate the appliance with a defective mains power cable.
- Have any repairs to or intervention in the appliance, and any change of the mains power cable, carried out by the customer service only or by other specialised personnel trained for the purpose.
- Only install, connect and dispose of the appliance according to the instructions.
- Only use the appliance when it is installed.
- Please keep these instructions in a safe place and pass them on to any subsequent owners.
- Special-purpose lamps (incandescent lamps, LEDs, fluorescent tubes) in the appliance serve to illuminate the appliance interior and are not suited for room illumination.

### Fire hazard:

- The refrigerant R 600a is environmentally friendly but flammable. Escaping refrigerant may ignite.
  - Do not damage the refrigerant circuit pipes.
  - Do not allow naked flames or ignition sources to enter the appliance.
  - Do not use any electrical appliances in the interior (e.g. steam cleaners, heaters, ice cream maker etc.).
  - If refrigerant escapes: remove any naked flames or sources of ignition from the leakage area. Ventilate the room well. Notify the after-sales service.
- Do not store explosives or sprays using combustible propellants such as butane, propane, pentane, etc. in the appliance. To identify these spray cans, look for the list of contents printed on the can, or a flame symbol. Gases possibly escaping may ignite due to electrical components.
- Always store high-percentage alcohol in tightly sealed, upright containers. Alcohol possibly escaping may ignite due to electrical components.

### Danger of tipping and falling:

## Controls and displays

- Do not misuse the plinth, drawers, doors etc. as a step or for support. This applies particularly to children.

### Danger of food poisoning:

- Do not consume food which has been stored too long.

### Danger of frostbite, numbness and pain:

- Avoid lasting skin contact with cold surfaces or refrigerated/frozen food or take protective steps, e.g. wear gloves. Do not consume ice cream, water ice or ice cubes immediately and do not consume them too cold.

### Risk of crushing

- Do not reach into the soft stop mechanism. Fingers may be trapped when the door is closed.

### Please observe the specific information in the other sections:

	DANGER	identifies a situation involving direct danger which, if not obviated, may result in death or severe bodily injury.
	WARNING	identifies a dangerous situation which, if not obviated, may result in death or severe bodily injury.
	CAUTION	identifies a dangerous situation which, if not obviated, may result in minor or medium bodily injury.
	NOTICE	identifies a dangerous situation which, if not obviated, may result in damage to property.
	Note	identifies useful information and tips.

## 3 Controls and displays

### 3.1 Operating and control elements

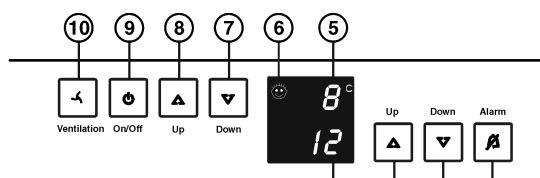

Fig. 3

- |  |  |
|--|--|
| (1) Lower wine zone temperature display  | (6) Child-proofing symbol                |
| (2) Up setting button, lower wine zone   | (7) Down setting button, upper wine zone |
| (3) Down setting button, lower wine zone | (8) Up setting button, upper wine zone   |
| (4) Alarm button                         | (9) On/Off button                        |
| (5) Upper wine zone temperature display  | (10) Fan button                          |

### 3.2 Temperature display

The following are displayed in normal operation:

- the average wine cabinet temperature

The temperature display flashes:

- the temperature setting is being changed
- the wine cabinet temperature is too cold/too warm

The following displays indicate malfunction. Possible causes and corrective action (see Malfunction).

- F0 to F5

## 4 Putting into operation

### 4.1 Transporting the appliance



#### CAUTION

Risk of injury and danger of damage as a result of incorrect transport!

- ▶ Transport the appliance in a packed condition.
- ▶ Transport the appliance upright.
- ▶ Do not transport the appliance without assistance.

### 4.2 Installing the appliance



#### WARNING

Risk of fire due to short circuit!

If the mains cable/connector of the appliance or of another appliance touch the rear of the appliance, the mains cable/connector may be damaged by the appliance vibrations, leading to a short circuit.

- ▶ Stand the appliance so that it is not touched by connectors or main cables.
- ▶ Do not plug the appliance or any others into sockets located near the rear of the appliance.



#### WARNING

Fire hazard due to dampness!

If live parts or the mains lead become damp this may cause short circuits.

- ▶ The appliance is designed for use in enclosed areas. Do not operate the appliance outdoors or in areas where it is exposed to splash water or damp conditions.
- ▶ Only use the appliance when it is installed.



#### WARNING

Fire hazard due to refrigerant!

The refrigerant R 600a is environmentally friendly but flammable. Escaping refrigerant may ignite.

- ▶ Do not damage the piping of the refrigeration circuit.



#### WARNING

Fire hazard and danger of damage!

▶ Do not place appliances emitting heat e.g. microwaves, toasters etc. on the appliance!

- In the event that the appliance is damaged, contact the supplier immediately before connecting to the mains.
- The floor at the site must be flat and level.
- Do not install the appliance in a location where it is exposed to direct radiation of the sun, next to a cooker, heater and similar.
- Do not install the appliance without assistance.

- ❑ Standard EN 378 specifies that the room in which you install your appliance must have a volume of 1 m<sup>2</sup> per 8 g of R 600a refrigerant used in the appliance. If the room in which the appliance is installed is too small, a flammable gas-air mixture may form in the event of a leakage in the refrigeration circuit. The quantity of refrigerant used in your appliance is indicated on the type plate on the inside of the appliance.
- ❑ Fit the appliance in stable kitchen units only.
- ❑ The following ventilation gaps must be observed:
  - The depth of the ventilation channel at the rear of the unit must be at least 38 mm.
  - There must be a ventilation space of at least 200 cm<sup>2</sup> in the plinth and at the top of the unit.
  - Basically the principle applies: the larger the ventilation space, the more energy-saving the appliance is in operation.

▶ Detach the connecting cable from the rear of the appliance, removing the cable holder at the same time because otherwise there will be vibratory noise!

After installation:

- ▶ Remove all transit supports.
- ▶ Unscrew the red transport lock. Close the vacated retaining hole using the stopper (60).

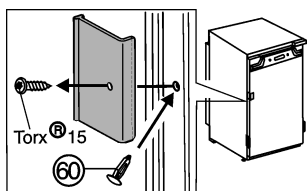

- ▶ Dispose of packaging material (see 4.5) .

### Note

- ▶ Clean the appliance (see 6.2) .

If the appliance is installed in a very damp environment, condensate may form on the outside of the appliance.

- ▶ Always see to good ventilation at the installation site.

## 4.3 Changing over door hinges

Ensure that the following tools are to hand:

- ❑ Crosstip screwdriver
- ❑ Flat-blade screwdriver
- ❑ • Cordless screwdriver Torx® 15
  - Cordless screwdriver Torx® 20
  - Cordless screwdriver Torx® 25
  - Cordless screwdriver Torx® 30

Slide the appliance 2/3 of the way into the recess.

Pull out the power plug.

Open the door.

### 4.3.1 Detach the soft stop mechanism

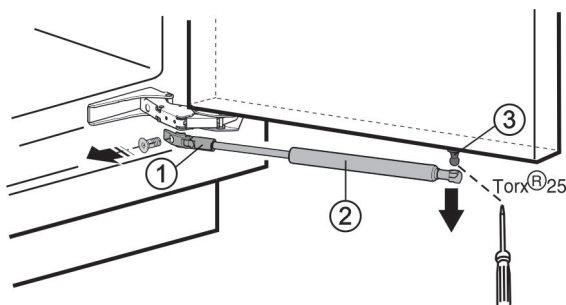

Fig. 4



### CAUTION

Risk of injury if soft stop contracts!

- ▶ Carefully remove the soft stop mechanism.

- ▶ Lower soft stop mechanism *Fig. 4 (2)* for removal.

- ▶ Unscrew holder *Fig. 4 (1)*.

- ▶ Unscrew the ball stud *Fig. 4 (3)* (Torx® 25).

### 4.3.2 Demount door

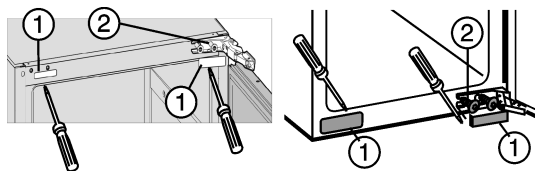

Fig. 5

- ▶ Lift off covers *Fig. 5 (1)*.

- ▶ Only slacken fastening screws *Fig. 5 (2)*.

- ▶ Remove door: push outwards, unhinge and set aside.

### 4.3.3 Changing bearing parts



### CAUTION

Risk of injury if hinges fold!

- ▶ Leave hinges open.

- ▶ Transfer top and bottom fastening screws *Fig. 5 (2)* to the opposite side.

Screws are self-tapping. Use cordless screwdriver:

- ▶ Unscrew *Fig. 6 (3)* the hinges from the door, transfer them and **screw them on tightly (4 Nm)**.

- ▶ Close vacated fastening holes with stoppers *Fig. 6 (4)*.

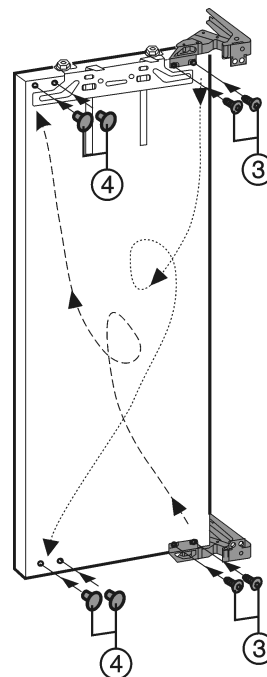

Fig. 6

### 4.3.4 Re-fit door

- ▶ Attach appliance door to the prefitted fastening screws *Fig. 5 (2)*.

- ▶ Screw in mounting screws *Fig. 5 (2)* **tightly (4 Nm)**.

- ▶ Re-fit covers *Fig. 5 (1)*.

# Putting into operation

## 4.3.5 Re-fit soft stop mechanism

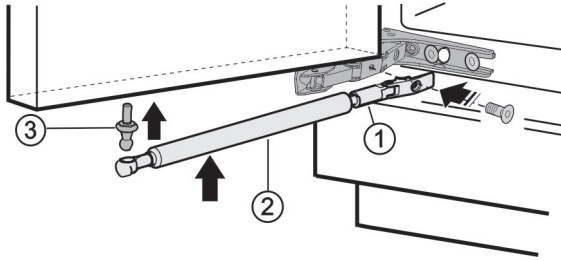

Fig. 7

- ▶ Screw the ball stud Fig. 7 (3) firmly into the new fastening hole (**with 4 Nm**) (Torx® 25).
- ▶ Screw on the bracket Fig. 7 (1) **tightly (3 Nm)**.
- ▶ Attach soft stop mechanism Fig. 7 (2) to ball stud.



### WARNING

- Risk of injury due to the door dropping out!  
If the fastening parts are not screwed into place firmly enough, the door may drop out. This may lead to severe injuries. What is more, the door may not close and therefore the appliance may fail to cool properly.
- ▶ Screw the hinges and the ball journal of the soft stop mechanism firmly into place, with 4 Nm.
  - ▶ Screw the holder of the soft stop mechanism firmly into place, with at least 3 Nm.
  - ▶ Check all of the screws and retighten if necessary.

## 4.4 Installation

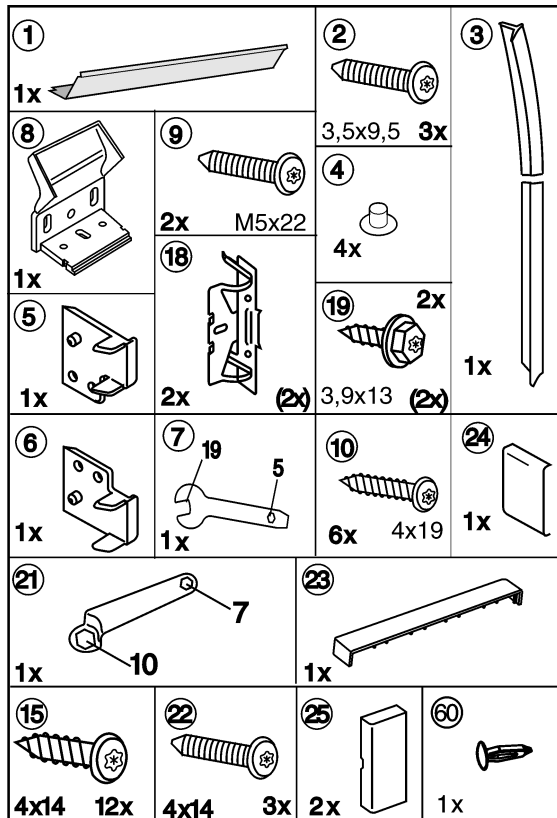

Fig. 8

Ensure that the following tools are to hand:

- Cordless screwdriver Torx®15, 20, 25
- Spanner 13
- Screwdriver

The shelf and side walls of the unit must be at right-angles to one another. Align the unit with a spirit level and an angle. If necessary, level out by building up from underneath.

In the case of side-by-side installation, two appliances next to one another, build the appliances into separate kitchen units.

### Note

- ▶ Before assembling the door of the unit, make sure that the admissible weight of the unit door is not exceeded.
- ▶ Otherwise damage to the hinges and resultant malfunction cannot be ruled out.

Model	Max. weight of unit door
WTI	20 kg

Check installation dimensions:

Appliance height a	Recess height b
1218 mm	1220 mm - 1236 mm

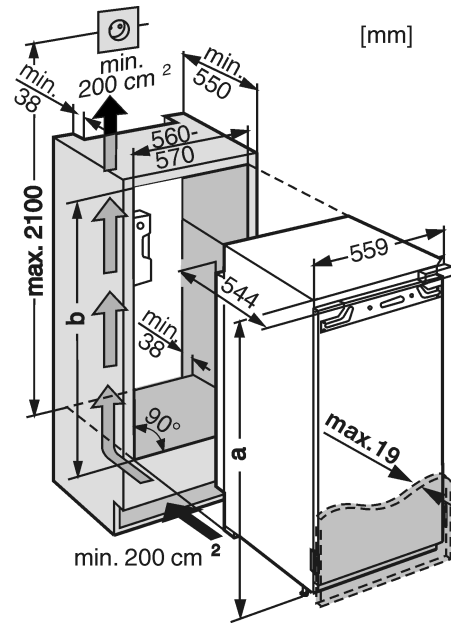

Fig. 9



## 4.4.1 Installing the appliance

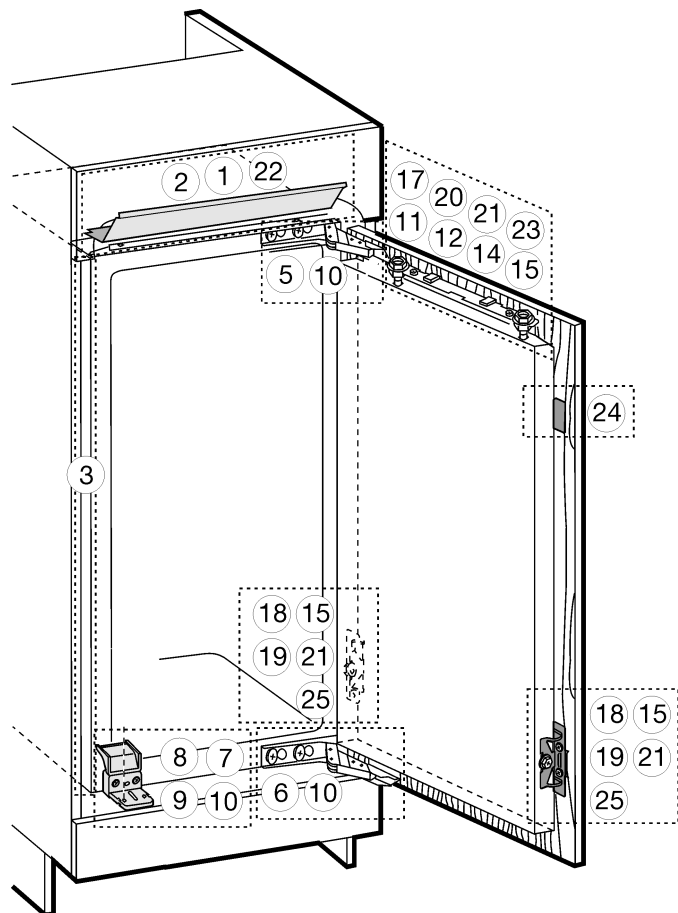

Fig. 10

- ▶ Detach the connecting cable from the rear of the appliance, removing the cable holder because otherwise there will be vibratory noise!
- ▶ Lay the connecting cable with the help of a string in such a way that the appliance can be easily connected after fitting.



Fig. 11

- ▶ Fit equaliser trim Fig. 12 (1) with screws Fig. 12 (2) onto the appliance.

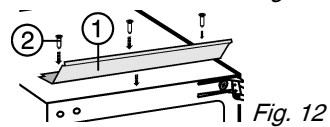

Fig. 12

- ▶ Slide the appliance 2/3 of the way into the recess.
- For 16 mm thick unit walls = 568 mm wide recess:**
- ▶ Clip spacer Fig. 13 (5) and spacer Fig. 10 (6) onto the hinges.

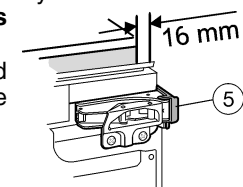

Fig. 13

- ▶ Screw plastic bracket Fig. 14 (8) onto the handle side of the appliance with M5 screws Fig. 14 (9).

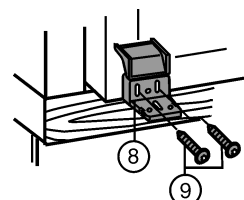

Fig. 14

**For 16 mm thick unit walls = 568 mm wide recess:**

- ▶ Remove the protective film from the cover trim Fig. 15 (3). Apply the strip on the side wall of the appliance on the handle side and flush with the front and glue on.
- ▶ If necessary, shorten the cover trim Fig. 15 (3) at the bottom.\*

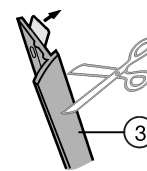

Fig. 15

**To slide in and align the appliance:**

- ▶ Slide in the appliance.

**For 16 mm thick unit walls = 568 mm wide recess:**

- ▶ Let the spacers abut the side wall of the unit.

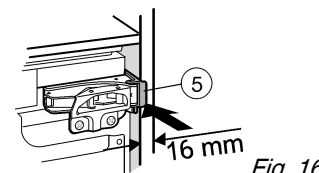

Fig. 16

**For 19 mm thick unit walls = 562 mm wide recess:**

- ▶ Align the front edges of the hinges so as to be flush with the side wall of the unit.

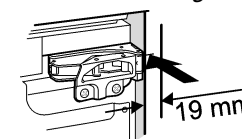

Fig. 17

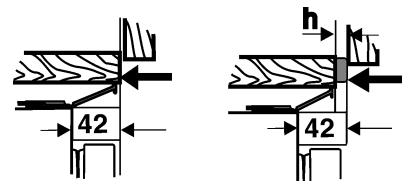

Fig. 18

**In case of units with (16 mm and 19 mm) door stop components (knobs, sealing lips etc.):**

- ▶ To allow for the extra distance (depth of door stop components): allow the hinges to protrude by the extra distance.

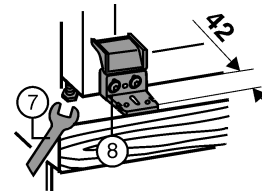

Fig. 19

**For units without door stop components:**

- ▶ Align the plastic bracket in depth so as to be flush with the front side of the side walls of the unit.

**For units with door stop components:**

- ▶ To allow for the extra distance : align the plastic bracket parallel to the front edge of the hinges.

**For units with set back base:**

- ▶ Align plastic bracket Fig. 19 (8) in depth so as to be flush with the front edges of the side walls of the unit, even if the bracket projects over the base of the unit as a result.
- ▶ Level the appliance by means of the adjustable feet using the accompanying spanner Fig. 19 (7).
- ▶ The appliance is now correctly positioned in depth. The distance between the front edge of the side wall of the unit and the body of the appliance is 42 mm all the way round (Allow for door stop components, such as knobs and sealing lips.)

### Note

Incorrect installation will lead to malfunction!  
If the distance is not kept, the door may not close. This may lead to icing, to condensate forming and to malfunction.

- ▶ Be sure to keep to a spacing of 42 mm all the way round. (Allow for door stop components, such as knobs and sealing lips.)

**Fasten the appliance in the recess with screws:**

## Putting into operation

- ▶ by screwing long Spax screws Fig. 20 (10) through the top and bottom hinge plates.

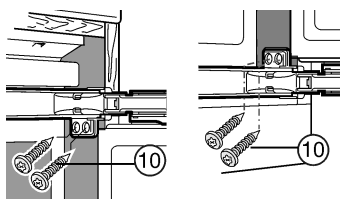

Fig. 20

- ▶ Pre-assemble by passing a long screw Fig. 21 (8) through the centre of the oblong hole in the plastic bracket Fig. 21 (10).
- ▶ Fold down the cover of the plastic bracket Fig. 21 (8).

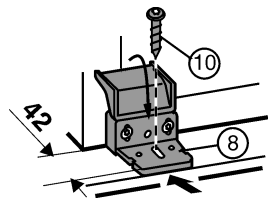

Fig. 21

- ▶ Close the appliance door.

### 4.4.2 Fitting the unit door

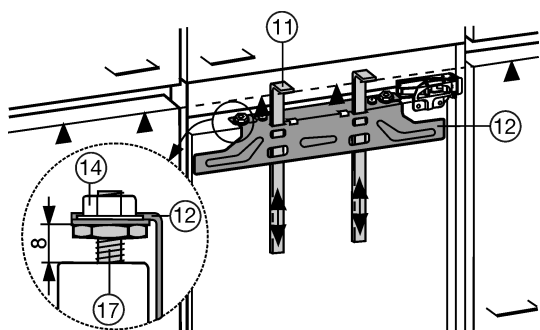

Fig. 22

- ▶ Check 8 mm presetting. (Distance between appliance door and lower edge of crosspiece)
- ▶ Push up assembly aids Fig. 22 (11) to unit door height. Lower edge ▲ of the assembly aid = top edge of the unit door to be fitted.
- ▶ Unscrew fastening crosspiece Fig. 23 (12) by undoing the locknuts Fig. 22 (14).
- ▶ Attach the fastening crosspiece using Fig. 23 (12) the assembly aids Fig. 23 (11) to the inside of the unit door.

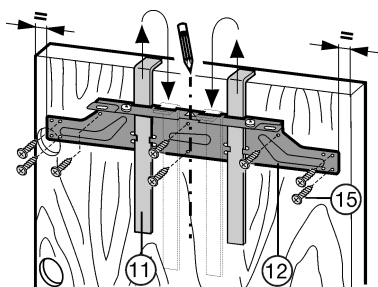

Fig. 23

- ▶ Centre the fastening crosspiece Fig. 23 (12): mark a short centre line on the unit door and put the tip of the arrow on the crosspiece above it.
- ▷ Distances to the outer edge are equal at the left and right.
  - For chipboard doors:
    - ▶ secure fastening crosspiece Fig. 23 (12) with at least 6 screws.
  - For frame and panel doors:
    - ▶ secure fastening crosspiece Fig. 23 (12) with 4 screws at the edge.
- ▶ Raise the assembly aids Fig. 23 (11) for removal, turn them and insert them into the adjacent openings.

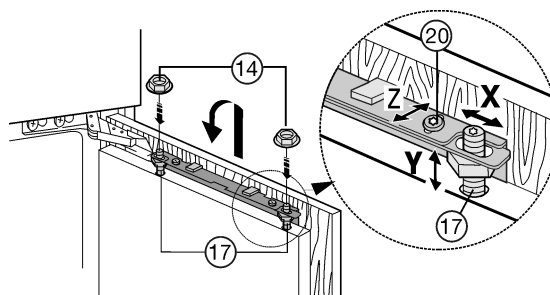

Fig. 24

- ▶ Attach the unit door to the adjusting bolts Fig. 24 (17) and loosely screw the locknuts Fig. 24 (14) onto them.
- ▶ Close the door.
- ▶ Check the gap between the door and the surrounding unit doors.
- ▶ To laterally align the unit door: move the unit door in the X direction.
- ▶ To align the unit door in height Y and in lateral inclination: adjust the adjusting bolt Fig. 24 (17) with a screwdriver.
- ▷ The unit door is flush and in alignment with the surrounding unit fronts.
- ▶ Tighten the locknuts Fig. 24 (14).
- ▶ Screw mounting bracket Fig. 25 (18) with hexagon screw Fig. 25 (19) into the pilot holes in the appliance door.

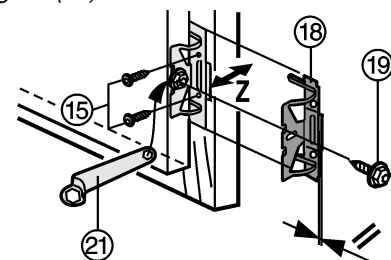

Fig. 25

Ensure that both metal edges are flush (symbol //):

- ▶ Drill pilot holes in the door of the unit (possibly make preliminary hole with a bradawl).
- ▶ Screw the appliance door to the unit door with screws Fig. 25 (15) passed through the mounting brackets Fig. 25 (18).

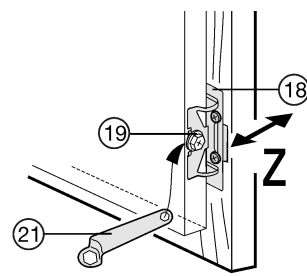
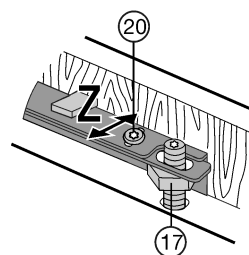
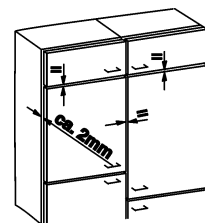

Fig. 26

- ▶ To align the unit door in depth Z: undo screws Fig. 26 (20) at the top, hexagon screws Fig. 26 (19) at the door, then move the door.
- ▶ Allow an air gap of approx. 2 mm between the unit door and the body of the unit.

Do not allow knobs and sealing lips to contact the door - important for function!

- For large or sectioned unit doors:
  - ▶ fit a 2nd pair of mounting brackets Fig. 25 (18).
  - ▶ Use the holes pre-drilled in the handle area of the appliance door for this purpose.





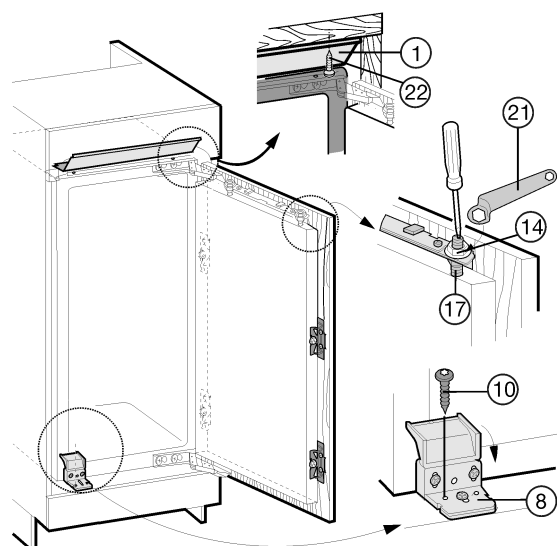

Fig. 27

- ▶ Check the fit of the door and readjust if necessary.
- ▶ Tighten all screws.
- ▶ Tighten the locknuts Fig. 27 (14) with the ring spanner Fig. 27 (21) while holding the adjusting bolts Fig. 27 (17), with a screwdriver.
- ▶ Screw the equaliser trim Fig. 27 (1) from below using three screws Fig. 27 (22) onto the cupboard ceiling.
- ▶ Fix the appliance in the round hole at the bottom with the second screw Fig. 27 (8) through the plastic bracket Fig. 27 (10).
- ▶ Snap covers into place.
- ▶ Attach top cover Fig. 28 (23) and snap into place.
- ▶ Attach side cover Fig. 28 (24), push it to the limit and then press until it audibly snaps into place.
- ▶ Attach covers Fig. 28 (25) sideways, then draw them forwards with a screwdriver so that they snap into place well.

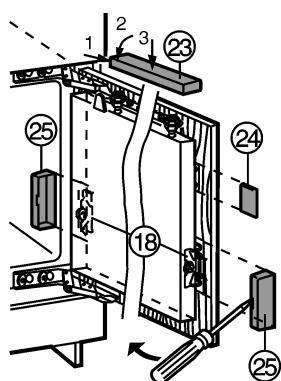

Fig. 28

## 4.5 Disposing of packaging



### WARNING

Danger of suffocation due to packing material and plastic film!  
▶ Do not allow children to play with packing material.

The packaging is made of recyclable materials:

- corrugated board/cardboard
- expanded polystyrene parts
- polythene bags and sheets
- polypropylene straps
- nailed wooden frame with polyethylene panel\*
- ▶ Take the packaging material to an official collecting point.



## 4.6 Connecting the appliance

### NOTICE

Risk of damage to the electronic control system!

- ▶ Do not use stand-alone inverters (conversion of d.c. to a.c./ three-phase) or energy saving plugs.



### WARNING

Fire and overheating hazard!

- ▶ Do not use extension cables or multiple socket outlets.

The type of current (alternating current) and voltage at the installation site have to conform with the data on the type plate (see Appliance at a glance).

The socket must be properly earthed and fused. The tripping current for the fuse must be between 10 A and 16 A.

The socket must be easily accessible so that the appliance can be quickly disconnected from the supply in an emergency. It must be outside the area of the rear of the appliance.

- ▶ Check the electrical connection.
- ▶ Plug in the power plug.



## 4.7 Switching on the appliance

- ▶ Press On/Off button Fig. 3 (9).
- ▷ The temperature display and the alarm button flash until the set temperature is reached.

## 5 Control

### 5.1 Brightness of the temperature display

You can adjust the brightness of the temperature display to the light conditions of the room in which the appliance is installed.

#### 5.1.1 Adjusting the brightness

The brightness is adjustable between h1 and h5 (maximum luminosity).

- ▶ To activate the setting mode: press the fan button Fig. 3 (10) for about 5s.
- ▷ The fan button Fig. 3 (10) flashes. The display indicates c.
- ▶ Using the Up setting button, upper wine zone Fig. 3 (8) and Down setting button, upper wine zone Fig. 3 (7) select h.
- ▶ To confirm: briefly press the fan button Fig. 3 (10).
- ▶ To set the display brighter: press the Up setting button, upper wine zone Fig. 3 (8).
- ▶ To set the display darker: press the Down setting button, upper wine zone Fig. 3 (7).
- ▶ To confirm: briefly press the fan button Fig. 3 (10).
- ▷ The brightness is adjusted to the new value.
- ▶ To deactivate the setting mode: press the On/Off button Fig. 3 (9).



-or-

- ▶ Wait for 5 minutes.
- ▷ The temperature is indicated again in the temperature display.

### 5.2 Child proofing

The child-proofing function enables you to make sure that the appliance is not inadvertently switched off by playing children.



#### 5.2.1 Setting the child-proofing function

- ▶ To activate the setting mode: press the fan button Fig. 3 (10) for about 5s.
- ▷ The fan button flashes. The display indicates c.
- ▶ Briefly press the fan button Fig. 3 (10) to confirm.

# Control

- ▶ To switch on: using the Up setting button, upper wine zone *Fig. 3 (8)* or Down setting button, upper wine zone *Fig. 3 (7)* select **c1**. 
  - ▶ To switch off: using the Up setting button, upper wine zone *Fig. 3 (8)* or Down setting button, upper wine zone *Fig. 3 (7)* select **c0**.
  - ▶ To confirm: press the fan button *Fig. 3 (10)*.
  - ▷ The child-proofing function is switched on when the child-proofing symbol *Fig. 3 (6)* shines.
  - ▶ To deactivate the setting mode: press the On/Off button *Fig. 3 (9)*.
- or-**
- ▶ Wait for 5 minutes.
  - ▷ The temperature is indicated again in the temperature display.

## 5.3 Door alarm

### 5.3.1 Muting the door alarm

The audible alarm can be muted when the door is open. The sound switch-off function is active as long as the door is left open.

- ▶ Press alarm button *Fig. 3 (4)*.
- ▷ The door alarm is silenced.

## 5.4 Temperature alarm

The audible alarm sounds if the wine storage temperature is too warm or too cold.

The temperature display flashes at the same time.



The cause of the temperature being too high may be:

- warm fresh food was placed inside
- too much warm ambient air flowed in when rearranging and removing food
- power failure for some time
- the appliance is faulty

The audible alarm is automatically silenced and the temperature display stops flashing when the temperature is sufficiently cold/warm again.

If the alarm status persists: (see Malfunction).

### Note

Food may be spoilt if the temperature is not cold enough.

- ▶ Check the quality of the food. Do not consume spoiled food.

## 5.5 Storing wine bottles

64 Bordeaux bottles (0,75 l) can be stored in the wine zone.

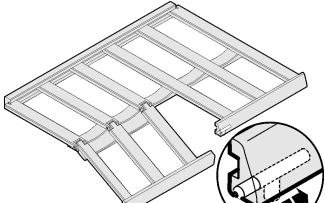
- ▶ Store white wine only in one compartment and red wine only in the other, since both compartments can be set to independent temperatures.
- ▶ If possible, lay bottles of the same type of wine side by side on the same grid shelf.
- ▶ Rearrange bottles as seldom as possible.
- ▶ Stored open bottles on the folded down wooden grid shelf.
- ▶ To fold down the wooden grid shelf: press the lock under the trim sideways.
- ▷ The wooden grid shelf folds down. 

## 5.6 Setting the temperature in the wine zone

The appliance is pre-set for normal operation. The temperature can be set from 20 °C to 5 °C, the recommended temperatures are 8 °C to 12 °C.

The wine zone is divided into two wine compartments, which can be set to different temperatures, as needed.

- ▶ To set the temperature warmer: press the Up setting button, upper wine zone *Fig. 3 (8)* or Up setting button, lower wine zone *Fig. 3 (2)*.
- ▶ To set the temperature colder: press the Down setting button, upper wine zone *Fig. 3 (7)* or Down setting button, lower wine zone *Fig. 3 (3)*.
- ▶ To change the temperature in 1 °C steps: briefly press the button.

**-or-**

- ▶ To change the temperature continuously: hold down the button.
- ▷ During setting the new value is displayed flashing.
- ▷ The actual temperature is displayed about 5 s after the last press of a button. The temperature slowly adjusts to the new value.

## 5.7 Fan

When the fan runs, the relative humidity in the interior increases so that the cork does not dry out.

When the fan is activated, the energy consumption increases. To save energy, the fan switches off automatically when the door is open.

### 5.7.1 Switching on the fan

- ▶ Briefly press the fan button *Fig. 3 (10)*. 

- ▷ The fan button *Fig. 3 (10)* shines.
- ▷ The fan always runs. The humidity is high.

### 5.7.2 Switch off the fan

- ▶ Briefly press the fan button *Fig. 3 (10)*.
- ▷ The fan button *Fig. 3 (10)* does not shine.
- ▷ The fan runs only when this is necessary for temperature control. The humidity is low.

## 5.8 Labels

You can note down on the labels the type of wine stored in the respective compartment. Additional labels can be obtained from your specialist dealer.

### 5.8.1 Labelling

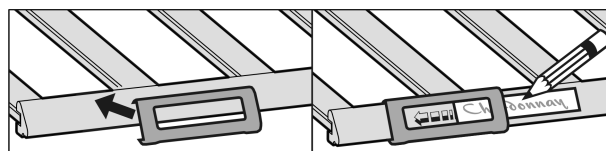

## 5.9 Wooden shelf

Pay attention that the wooden shelf does not get caught on the rear hook.

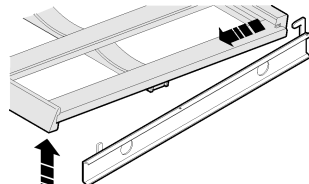
- ▶ To remove the folding wooden shelf: lift it off the pull-out rail and draw it forwards. 

- ▶ To insert the wooden folding shelf: slide it under the rear hook and press onto the rails so that they audibly snap into place.
- ▶ To insert other wooden shelves: place on the rails.

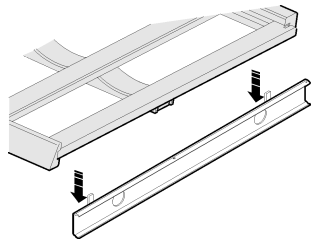

- ▶ Wipe the **rubber lip on the control panel** with a damp cloth and pH-neutral cleaning agent.

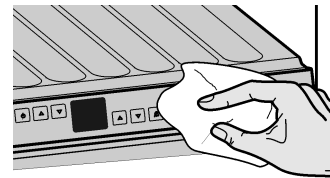

- ▶ Wipe **wooden grid shelves** with a dry lint-free cloth.

**Note**

- ▶ Do not clean wooden grid shelves with water and washing-up liquid.

- ▶ Clean **other items of equipment** by hand with lukewarm water and a little washing-up liquid.

**After cleaning:**

- ▶ Wipe dry the appliance and items of equipment.
- ▶ Connect the appliance and switch it on again.
- ▶ Put the food back inside.

## 6 Maintenance

### 6.1 Replacing the activated charcoal filter

The activated charcoal filter ensures ideal air quality and should therefore be replaced annually. It can be ordered from a specialised dealer.

Each wine zone is equipped with an activated charcoal filter of its own.

- ▶ Take the activated charcoal filter by the grip.
- ▶ Turn the activated charcoal filter through 90° to the right or left *Fig. 29 (1)*.
- ▶ Remove *Fig. 29 (2)* the activated charcoal filter.
- ▶ Insert the new activated charcoal filter with the grip in an upright position.
- ▶ Turn the new activated charcoal filter through 90° to the right or left *Fig. 29 (1)* until it snaps into place.

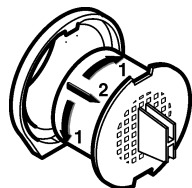

*Fig. 29*

### 6.2 Cleaning the appliance



**CAUTION**

Risk of injury and damage as a result of hot steam! Hot steam may damage the surfaces and cause burns.

- ▶ Do not use any steam cleaners!

**NOTICE**

Incorrect cleaning damages the appliance!

- ▶ Do not use cleaning agents in concentrated form.
- ▶ Do not use any scouring or abrasive sponges or steel wool.
- ▶ Please do not use any aggressive, scouring, sand-, chloride-, chemical- or acid-based cleaning agents.
- ▶ Do not use chemical solvents.
- ▶ Do not damage or remove the type plate on the inside of the appliance. It is important for the customer service.
- ▶ Do not pull off, bend or damage cables or other components.
- ▶ Do not allow any cleaning water to enter the drain channel, ventilation grille or electrical parts.
- ▶ Please use soft cleaning cloths and a universal pH-neutral cleaning agent.
- ▶ Please use cleaning and care products suitable for contact with foodstuffs in the appliance interior.

- ▶ **Empty appliance.**
- ▶ **Pull out the power plug.**



- ▶ Clean **plastic outer and inner surfaces** with lukewarm water and a little washing-up liquid.

### 6.3 Customer service

First check whether you can correct the fault yourself by reference to the list (see Malfunction). If this is not the case, please contact the customer service whose address is given in the enclosed customer service list.



**WARNING**

Risk of injury if repair work is not carried out professionally!

- ▶ Have any repairs and action - not expressly specified - on the appliance and mains cable carried out by service personnel only. (see Maintenance)

- ▶ Read the appliance designation *Fig. 30 (1)*, service No. *Fig. 30 (2)* and serial No. *Fig. 30 (3)* off the type plate located inside the appliance on the left-hand side.

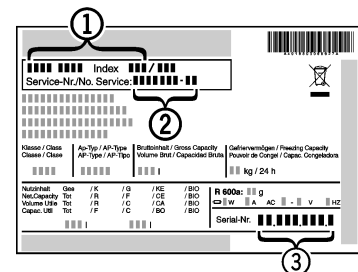

*Fig. 30*

- ▶ Notify the customer service, specifying the fault, appliance designation *Fig. 30 (1)*, service No. *Fig. 30 (2)* and serial No. *Fig. 30 (3)*.
- ▶ This will help us to provide you with a faster and more accurate service.
- ▶ Keep the appliance closed until the customer service arrives.
- ▶ The food will stay cool longer.
- ▶ Pull out the mains plug (not by pulling the connecting cable) or switch off the fuse.

## 7 Malfunction

Your appliance is designed and manufactured for a long life span and reliable operation. If a malfunction nonetheless occurs during operation, check whether it is due to a handling error. In this case you will have to be charged for the costs incurred, even during the warranty period. You may be able to rectify the following faults yourself:

**Appliance does not work.**

- The appliance is not switched on.
- ▶ Switch on the appliance.
- The power plug is not properly inserted in the wall socket.
- ▶ Check power plug.
- The fuse of the wall socket is not in order.

# Decommissioning

- ▶ Check fuse.

## The compressor runs for a long time.

- The compressor switches to a low speed when little cold is needed. Although the running time is increased as a result, energy is saved.
- ▶ This is normal in energy-saving models.

## A LED on the bottom rear of the appliance (at the compressor) flashes regularly every 15 seconds\*.

- The inverter is equipped with a diagnostic LED.
- ▶ The flashing is normal.

## Excessive noise.

- Speed-controlled\* compressors may produce varying running noise due to different speed steps.
- ▶ The sound is normal.

## A bubbling and gurgling noise.

- This noise comes from the refrigerant flowing in the refrigeration circuit.
- ▶ The sound is normal.

## A quiet clicking noise.

- The noise is produced whenever the refrigeration unit (motor) automatically switches on or off.
- ▶ The sound is normal.

## A hum. It is briefly a little louder when the refrigeration unit (the motor) switches on.

- The refrigeration increases automatically when fresh food has just been placed in the appliance or the door has been left open for a while.
- ▶ The sound is normal.
- The ambient temperature is too high.
- ▶ Solution: (see 1.2)

## A low hum.

- The sound is produced by air flow noise of the fan.
- ▶ The sound is normal.

## Mould on wine bottles

- Similarly as with other forms of storage, a little mould may form depending on the type of adhesive used for the label.
- ▶ Remove residual adhesive.

## The temperature display indicates: F0 to F5.

- There is a fault.
- ▶ Contact the customer service (see Maintenance).

## The temperature is not cold enough.

- The door of the appliance is not properly closed.
- ▶ Close the door of the appliance.
- Insufficient ventilation.
- ▶ Clear ventilation grilles.
- The ambient temperature is too high.
- ▶ Solution: (see 1.2) .
- The appliance was opened too frequently or for too long.
- ▶ Wait until the appliance reaches the required temperature itself. If not, contact the customer service. (see Maintenance).
- The temperature is incorrectly set.
- ▶ Set the temperature to a colder setting and check after 24 hours.
- The appliance is too close to a source of heat (stove, heater etc).
- ▶ Change the position of the appliance or the source of heat.

## The interior light is not on.

- The appliance is not switched on.
- ▶ Switch on the appliance.
- The door was open longer than 15 min.
- ▶ The interior light automatically switches off if the door has been open for about 15 min.
- The LED lighting is defective or the cover is damaged:



### WARNING

Risk of injury due to electric shock!  
Live parts are located under the cover.

- ▶ Have the LED interior light changed or repaired only by the customer service or by specialized personnel trained for the purpose.



### WARNING

Danger of injury due to laser radiation, class 1M.

- ▶ Do not look inside when the cover is open.

## 8 Decommissioning

### 8.1 Switching off the appliance

- ▶ Press On/Off button *Fig. 3 (9)* for approx. 2 seconds.
- ▷ The temperature display is dark.
- ▷ If the appliance cannot be switched off, the child lock function is active (see 5.2) .



### 8.2 Taking the appliance out of service

- ▶ Empty the appliance.
- ▶ Pull out the power plug.
- ▶ Clean the appliance (see 6.2) .



- ▶ Leave the door open to prevent odour.

## 9 Disposing of the appliance

The appliance contains some reusable materials and should be disposed of properly - not simply with unsorted household refuse. Appliances which are no longer needed must be disposed of in a professional and appropriate way, in accordance with the current local regulations and laws.

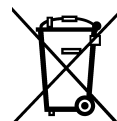

When disposing of the appliance, ensure that the refrigeration circuit is not damaged to prevent uncontrolled escape of the refrigerant it contains (data on type plate) and oil.

- ▶ Disable the appliance.
- ▶ Pull out the plug.
- ▶ Cut through the connecting cable.